

GBD Series

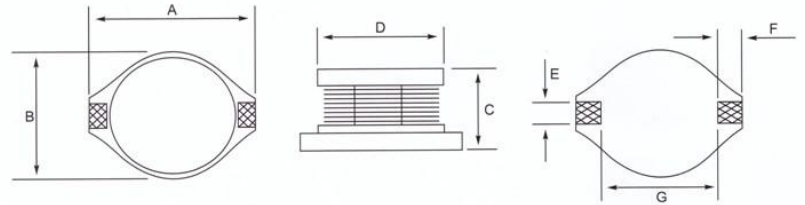

● Dimensions and Land Patterns. (UNIT: mm)



TYPE	A max	B max	C max	D	E	F	G
GBD1608	6.90	4.50	2.90	4.00	1.20	1.15	4.20
GBD3316	13.5	10.0	5.20	8.40	2.54	2.54	7.62
GBD3340	14.5	10.0	11.4	8.40	2.54	2.54	7.62
GBD5022	19.0	14.3	6.80	12.7	2.54	2.54	12.7

● Features:

High energy storage
Low resistance

● Applications:

Notebook, Desktop, Modem
equipment, LCD,OA equipment,
other electronic equipment

● Part Numbering

GBD 5022 K T 100

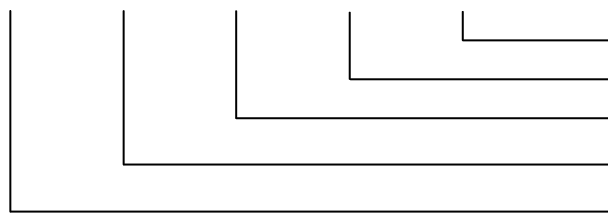

Inductance Value: 100:10uH
Packaging Code: Taping Reel
Inductance Tolerance: M: ±20% K: ±10%
Dimensions:1608 3316 3340 5022
Product Type

● Operating temperature: -40 °C to +125° C

Electrical characteristics List

GBD1608 Series

PART No.	L(uH)	Tolerance	Test Condition	DCR (Ω)MAX	IDC (A)
GBD1608MT1R0	1.0	M	100KHZ/0.25V	0.030	2.880
GBD1608MT1R5	1.5	M	100KHZ/0.25V	0.034	2.700
GBD1608MT2R2	2.2	M	100KHZ/0.25V	0.047	2.250
GBD1608MT3R3	3.3	M	100KHZ/0.25V	0.065	1.750
GBD1608MT3R9	3.9	M	100KHZ/0.25V	0.070	1.600
GBD1608MT4R7	4.7	M	100KHZ/0.25V	0.086	1.400
GBD1608MT5R6	5.6	M	100KHZ/0.25V	0.102	1.350
GBD1608MT6R8	6.8	M	100KHZ/0.25V	0.117	1.300
GBD1608MT8R2	8.2	M	100KHZ/0.25V	0.162	1.200
GBD1608KT100	10	K	1KHZ/0.25V	0.189	1.050
GBD1608KT150	15	K	1KHZ/0.25V	0.286	0.810
GBD1608KT220	22	K	1KHZ/0.25V	0.364	0.700
GBD1608KT270	27	K	1KHZ/0.25V	0.510	0.615
GBD1608KT330	33	K	1KHZ/0.25V	0.650	0.530
GBD1608KT390	39	K	1KHZ/0.25V	0.710	0.490
GBD1608KT470	47	K	1KHZ/0.25V	0.845	0.450
GBD1608KT560	56	K	1KHZ/0.25V	0.930	0.400
GBD1608KT680	68	K	1KHZ/0.25V	1.120	0.370
GBD1608KT820	82	K	1KHZ/0.25V	1.460	0.355
GBD1608KT101	100	K	1KHZ/0.25V	1.660	0.310
GBD1608KT151	150	K	1KHZ/0.25V	2.930	0.220
GBD1608KT221	220	K	1KHZ/0.25V	3.900	0.180
GBD1608KT331	330	K	1KHZ/0.25V	6.310	0.160

Electrical characteristics List
GBD3316/3340/5022 Series

PART No.	L (μ H)	Tolerance	Test Condition	DCR (Ω)MAX			IDC (A)		
				3316	3340	5022	3316	3340	5022
GBD◇◇MT1R0	1.0	M	100KHZ/0.25V	0.008	0.008	0.006	6.300	9.800	10.20
GBD◇◇MT1R5	1.5	M	100KHZ/0.25V	0.009	0.012	0.007	5.700	8.500	8.500
GBD◇◇MT2R2	2.2	M	100KHZ/0.25V	0.012	0.013	0.008	5.000	8.000	7.200
GBD◇◇MT3R3	3.3	M	100KHZ/0.25V	0.018	0.014	0.013	4.300	7.000	6.300
GBD◇◇MT3R9	3.9	M	100KHZ/0.25V	0.020	0.015	0.015	4.000	6.800	6.60
GBD◇◇MT4R7	4.7	M	100KHZ/0.25V	0.021	0.015	0.017	3.780	6.500	5.800
GBD◇◇MT5R6	5.6	M	100KHZ/0.25V	0.025	0.016	0.020	3.700	6.200	5.300
GBD◇◇MT6R8	6.8	M	100KHZ/0.25V	0.029	0.017	0.021	3.500	5.200	4.900
GBD◇◇MT8R2	8.2	M	100KHZ/0.25V	0.031	0.022	0.022	3.400	4.100	4.500
GBD◇◇KT100	10	K	1KHZ/0.25V	0.036	0.030	0.023	3.060	3.800	4.300
GBD◇◇KT150	15	K	1KHZ/0.25V	0.056	0.036	0.033	2.800	3.000	3.850
GBD◇◇KT220	22	K	1KHZ/0.25V	0.075	0.052	0.052	2.250	2.700	3.150
GBD◇◇KT270	27	K	1KHZ/0.25V	0.091	0.063	0.058	1.980	2.500	2.750
GBD◇◇KT330	33	K	1KHZ/0.25V	0.111	0.070	0.075	1.800	2.300	2.500
GBD◇◇KT390	39	K	1KHZ/0.25V	0.121	0.082	0.080	1.710	2.000	2.400
GBD◇◇KT470	47	K	1KHZ/0.25V	0.156	0.099	0.098	1.620	1.800	2.100
GBD◇◇KT560	56	K	1KHZ/0.25V	0.178	0.122	0.105	1.500	1.700	2.000
GBD◇◇KT680	68	K	1KHZ/0.25V	0.208	0.144	0.120	1.330	1.620	1.800
GBD◇◇KT820	82	K	1KHZ/0.25V	0.260	0.166	0.155	1.210	1.350	1.700
GBD◇◇KT101	100	K	1KHZ/0.25V	0.317	0.182	0.218	1.080	1.100	1.350
GBD◇◇KT151	150	K	1KHZ/0.25V	0.471	0.334	0.317	0.900	1.050	1.150
GBD◇◇KT181	180	K	1KHZ/0.25V	0.533	0.388	0.350	0.792	1.000	1.050
GBD◇◇KT221	220	K	1KHZ/0.25V	0.663	0.436	0.433	0.720	0.165	1.000
GBD◇◇MT331	330	K	1KHZ/0.25V	1.030	0.689	0.844	0.600	0.670	0.840
GBD◇◇MT391	390	K	1KHZ/0.25V	1.210	0.890	0.850	0.550	0.600	0.720
GBD◇◇MT471	470	K	1KHZ/0.25V	1.500	1.000	0.932	0.500	0.540	0.675
GBD◇◇MT561	560	K	1KHZ/0.25V	1.700	1.330	1.160	0.405	0.495	0.585
GBD◇◇MT681	680	K	1KHZ/0.25V	2.080	1.430	1.470	0.350	0.460	0.530
GBD◇◇MT821	820	K	1KHZ/0.25V	2.500	1.880	1.750	0.300	0.460	0.490
GBD◇◇MT102	1000	K	1KHZ/0.25V	3.120	2.080	2.050	0.270	0.430	0.440