

DLCH Series

● Dimensions and Land Patterns. (UNIT:mm)

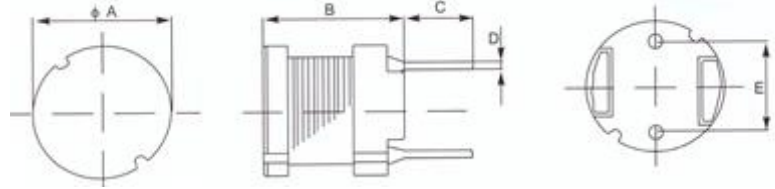

Type	ΦA	B(max)	C	D	E
DLCH654	6.5	5.0	2.5	0.5	4.0
DLCH855	8.3	5.5	2.5	0.7	5.0
DLCH875	8.3	7.5	2.5	0.7	5.0
DLCH895	8.3	9.8	2.5	0.7	5.0

● Part Numbering

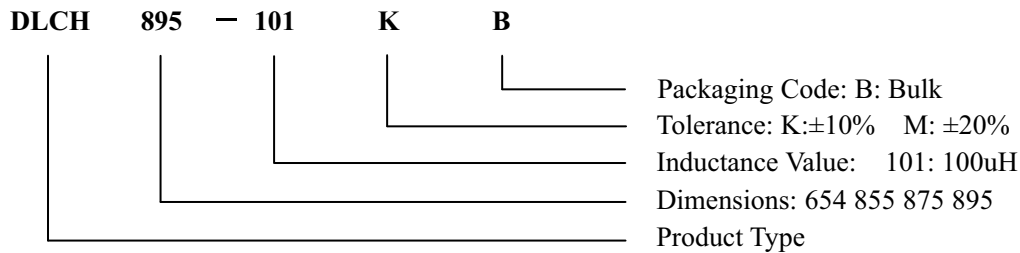

Electrical characteristics List

DLCH654 Series

PART No.	L (μH)	Tolerance	Test Condition	RDC Max.(Ω)	IDC Max. (A)
DLCH654-1R0MB	1.0	M	100KHZ/0.25V	0.029	3.00
DLCH654-3R3MB	3.3	M	100KHZ/0.25V	0.048	1.98
DLCH654-5R6MB	5.6	M	100KHZ/0.25V	0.066	1.53
DLCH654-8R2MB	8.2	M	100KHZ/0.25V	0.085	1.26
DLCH654-100KB	10	K	1KHZ/0.25V	0.091	1.20
DLCH654-150KB	15	K	1KHZ/0.25V	0.120	0.98
DLCH654-220KB	22	K	1KHZ/0.25V	0.180	0.90
DLCH654-330KB	33	K	1KHZ/0.25V	0.270	0.74
DLCH654-390KB	39	K	1KHZ/0.25V	0.290	0.68
DLCH654-560KB	56	K	1KHZ/0.25V	0.420	0.57
DLCH654-680KB	68	K	1KHZ/0.25V	0.480	0.51
DLCH654-820KB	82	K	1KHZ/0.25V	0.550	0.47
DLCH654-101KB	100	K	1KHZ/0.25V	0.680	0.42
DLCH654-151KB	150	K	1KHZ/0.25V	0.950	0.35
DLCH654-221KB	220	K	1KHZ/0.25V	1.30	0.29
DLCH654-331KB	330	K	1KHZ/0.25V	2.18	0.23
DLCH654-391KB	390	K	1KHZ/0.25V	2.47	0.21
DLCH654-471KB	470	K	1KHZ/0.25V	2.92	0.20
DLCH654-561KB	560	K	1KHZ/0.25V	3.97	0.18
DLCH654-681KB	680	K	1KHZ/0.25V	4.57	0.16
DLCH654-821KB	820	K	1KHZ/0.25V	5.28	0.15
DLCH654-102KB	1000	K	1KHZ/0.25V	7.06	0.13

Electrical characteristics List

DLCH855 Series

PART No.	L (μ H)	Tolerance	Test Condition	RDC Max.(Ω)	IDC Max. (A)
DLCH855-1R0MB	1.0	M	100KHZ/0.25V	0.016	3.70
DLCH855-1R5MB	1.5	M	100KHZ/0.25V	0.018	3.00
DLCH855-2R2MB	2.2	M	100KHZ/0.25V	0.020	3.50
DLCH855-2R7MB	2.7	M	100KHZ/0.25V	0.023	3.70
DLCH855-3R3MB	3.3	M	100KHZ/0.25V	0.026	3.24
DLCH855-3R9MB	3.9	M	100KHZ/0.25V	0.029	3.16
DLCH855-4R7MB	4.7	M	100KHZ/0.25V	0.033	2.92
DLCH855-5R6MB	5.6	M	100KHZ/0.25V	0.037	2.77
DLCH855-6R8MB	6.8	M	100KHZ/0.25V	0.042	2.52
DLCH855-8R2MB	8.2	M	100KHZ/0.25V	0.045	2.28
DLCH855-100KB	10	K	1KHZ/0.25V	0.070	1.56
DLCH855-120KB	12	K	1KHZ/0.25V	0.080	1.32
DLCH855-150KB	15	K	1KHZ/0.25V	0.090	1.14
DLCH855-180KB	18	K	1KHZ/0.25V	0.100	1.08
DLCH855-220KB	22	K	1KHZ/0.25V	0.120	0.92
DLCH855-270KB	27	K	1KHZ/0.25V	0.140	0.87
DLCH855-330KB	33	K	1KHZ/0.25V	0.170	0.80
DLCH855-390KB	39	K	1KHZ/0.25V	0.210	0.70
DLCH855-470KB	47	K	1KHZ/0.25V	0.240	0.68
DLCH855-560KB	56	K	1KHZ/0.25V	0.310	0.60
DLCH855-680KB	68	K	1KHZ/0.25V	0.340	0.56
DLCH855-820KB	82	K	1KHZ/0.25V	0.400	0.51
DLCH855-101KB	100	K	1KHZ/0.25V	0.520	0.45
DLCH855-121KB	120	K	1KHZ/0.25V	0.590	0.43
DLCH855-151KB	150	K	1KHZ/0.25V	0.710	0.39
DLCH855-181KB	180	K	1KHZ/0.25V	0.890	0.36
DLCH855-221KB	220	K	1KHZ/0.25V	1.04	0.34
DLCH855-271KB	270	K	1KHZ/0.25V	1.28	0.30
DLCH855-331KB	330	K	1KHZ/0.25V	1.47	0.28
DLCH855-391KB	390	K	1KHZ/0.25V	1.67	0.26
DLCH855-471KB	470	K	1KHZ/0.25V	1.95	0.24
DLCH855-561KB	560	K	1KHZ/0.25V	2.83	0.19
DLCH855-681KB	680	K	1KHZ/0.25V	3.25	0.18
DLCH855-821KB	820	K	1KHZ/0.25V	3.82	0.17
DLCH855-102KB	1000	K	1KHZ/0.25V	5.30	0.15

Electrical characteristics List
DLCH875 Series

PART No.	L (μ H)	Tolerance	Test Condition	RDC Max.(Ω)	IDC Max. (A)
DLCH875-1R0MB	1.0	M	100KHZ/0.25V	0.011	4.10
DLCH875-1R5MB	1.5	M	100KHZ/0.25V	0.012	4.00
DLCH875-2R2MB	2.2	M	100KHZ/0.25V	0.013	3.90
DLCH875-2R7MB	2.7	M	100KHZ/0.25V	0.015	3.50
DLCH875-3R3MB	3.3	M	100KHZ/0.25V	0.017	3.40
DLCH875-3R9MB	3.9	M	100KHZ/0.25V	0.018	3.25
DLCH875-4R7MB	4.7	M	100KHZ/0.25V	0.020	3.16
DLCH875-5R6MB	5.6	M	100KHZ/0.25V	0.022	2.90
DLCH875-6R8MB	6.8	M	100KHZ/0.25V	0.023	2.80
DLCH875-8R2MB	8.2	M	100KHZ/0.25V	0.026	2.54
DLCH875-100KB	10	K	1KHZ/0.25V	0.050	2.30
DLCH875-120KB	12	K	1KHZ/0.25V	0.060	2.15
DLCH875-150KB	15	K	1KHZ/0.25V	0.070	1.68
DLCH875-180KB	18	K	1KHZ/0.25V	0.080	1.55
DLCH875-220KB	22	K	1KHZ/0.25V	0.090	1.44
DLCH875-270KB	27	K	1KHZ/0.25V	0.110	1.20
DLCH875-330KB	33	K	1KHZ/0.25V	0.130	1.10
DLCH875-390KB	39	K	1KHZ/0.25V	0.140	1.05
DLCH875-470KB	47	K	1KHZ/0.25V	0.150	1.00
DLCH875-560KB	56	K	1KHZ/0.25V	0.180	0.88
DLCH875-680KB	68	K	1KHZ/0.25V	0.200	0.82
DLCH875-820KB	82	K	1KHZ/0.25V	0.240	0.76
DLCH875-101KB	100	K	1KHZ/0.25V	0.350	0.70
DLCH875-121KB	120	K	1KHZ/0.25V	0.360	0.60
DLCH875-151KB	150	K	1KHZ/0.25V	0.420	0.55
DLCH875-181KB	180	K	1KHZ/0.25V	0.570	0.49
DLCH875-221KB	220	K	1KHZ/0.25V	0.630	0.46
DLCH875-271KB	270	K	1KHZ/0.25V	0.880	0.38
DLCH875-331KB	330	K	1KHZ/0.25V	1.05	0.36
DLCH875-391KB	390	K	1KHZ/0.25V	1.17	0.35
DLCH875-471KB	470	K	1KHZ/0.25V	1.34	0.34
DLCH875-561KB	560	K	1KHZ/0.25V	1.72	0.28
DLCH875-681KB	680	K	1KHZ/0.25V	1.96	0.26
DLCH875-821KB	820	K	1KHZ/0.25V	2.56	0.23
DLCH875-102KB	1000	K	1KHZ/0.25V	2.94	0.22

Electrical characteristics List

DLCH895 Series

PART No.	L (μ H)	Tolerance	Test Condition	RDC Max.(Ω)	IDC Max. (A)
DLCH895-1R0MB	1.0	M	100KHZ/0.25V	0.011	4.60
DLCH895-1R5MB	1.5	M	100KHZ/0.25V	0.012	4.30
DLCH895-2R2MB	2.2	M	100KHZ/0.25V	0.013	4.20
DLCH895-2R7MB	2.7	M	100KHZ/0.25V	0.014	3.90
DLCH895-3R3MB	3.3	M	100KHZ/0.25V	0.015	3.70
DLCH895-3R9MB	3.9	M	100KHZ/0.25V	0.016	3.30
DLCH895-4R7MB	4.7	M	100KHZ/0.25V	0.018	3.10
DLCH895-5R6MB	5.6	M	100KHZ/0.25V	0.020	3.00
DLCH895-6R8MB	6.8	M	100KHZ/0.25V	0.021	2.85
DLCH895-8R2MB	8.2	M	100KHZ/0.25V	0.023	2.60
DLCH895-100KB	10	K	1KHZ/0.25V	0.040	2.40
DLCH895-120KB	12	K	1KHZ/0.25V	0.043	2.28
DLCH895-150KB	15	K	1KHZ/0.25V	0.050	2.10
DLCH895-180KB	18	K	1KHZ/0.25V	0.052	1.90
DLCH895-220KB	22	K	1KHZ/0.25V	0.060	1.68
DLCH895-270KB	27	K	1KHZ/0.25V	0.062	1.55
DLCH895-330KB	33	K	1KHZ/0.25V	0.070	1.32
DLCH895-390KB	39	K	1KHZ/0.25V	0.080	1.25
DLCH895-470KB	47	K	1KHZ/0.25V	0.100	1.18
DLCH895-560KB	56	K	1KHZ/0.25V	0.110	1.08
DLCH895-680KB	68	K	1KHZ/0.25V	0.140	0.97
DLCH895-820KB	82	K	1KHZ/0.25V	0.160	0.91
DLCH895-101KB	100	K	1KHZ/0.25V	0.190	0.87
DLCH895-121KB	120	K	1KHZ/0.25V	0.220	0.80
DLCH895-151KB	150	K	1KHZ/0.25V	0.270	0.72
DLCH895-181KB	180	K	1KHZ/0.25V	0.310	0.65
DLCH895-221KB	220	K	1KHZ/0.25V	0.380	0.60
DLCH895-271KB	270	K	1KHZ/0.25V	0.530	0.49
DLCH895-331KB	330	K	1KHZ/0.25V	0.610	0.47
DLCH895-391KB	390	K	1KHZ/0.25V	0.690	0.44
DLCH895-471KB	470	K	1KHZ/0.25V	0.890	0.38
DLCH895-561KB	560	K	1KHZ/0.25V	1.05	0.36
DLCH895-681KB	680	K	1KHZ/0.25V	1.18	0.32
DLCH895-821KB	820	K	1KHZ/0.25V	1.57	0.29
DLCH895-102KB	1000	K	1KHZ/0.25V	1.85	0.26