

GBF Series

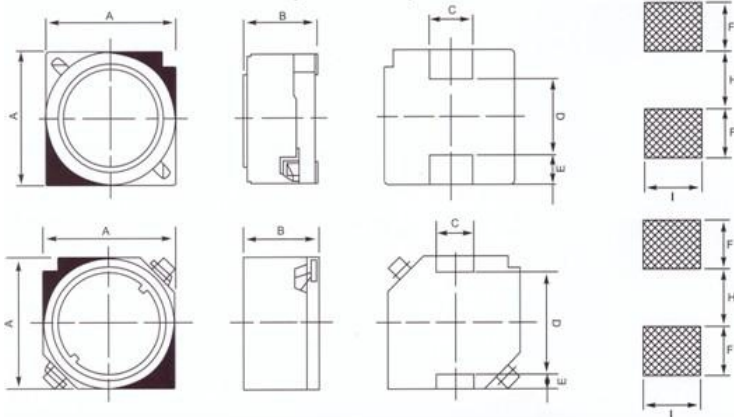

● Dimensions and Land Patterns. (UNIT: mm)



● Applications:

Ideal use in variety of DC-DC converter inductor applications Mobife Phone ,PDA , Notebook, MP3, LCD monitors, LED.

● Operating temperature: -40 °C to +125 °C

TYPE	A	B(max)	C	D	E	I	F	H
GBF6028	6.0±0.2	3.0	2.0	3.0	1.5	2.2	2.0	2.5
GBF7025	7.0±0.2	2.8	2.0	4.0	1.5	2.2	2.0	3.5
GBF7032	7.0±0.2	3.4	2.0	4.0	1.5	2.2	2.0	3.5
GBF7045	7.0±0.2	4.8	2.0	4.0	2.0	2.2	2.0	3.5
GBF7055	7.0±0.2	5.8	2.0	4.0	2.0	2.2	2.0	3.5
GBF1045	10.1±0.3	4.8	3.0	6.0	3.0	3.2	2.5	5.6
GBF1065	10.1±0.3	6.9	3.0	6.0	3.0	3.2	2.5	5.6
GBF1255	12.5±0.3	5.9	3.0	8.6	3.0	3.2	2.5	8.6
GBF1265	12.5±0.3	6.9	3.0	8.6	3.0	3.2	2.5	8.6
GBF1275	12.5±0.3	7.9	3.0	8.6	3.0	3.2	2.5	8.6

● Part Numbering

GBF 7045 M T 330

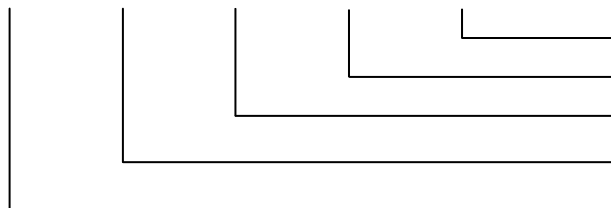

Inductance Value: 330:33uH
 Packaging Code: Taping Reel
 Inductance Tolerance: K: ±10% M: ±20% N: ±30%
 Dimensions: 6028 7025 7032
 Product Type

Electrical characteristics List

GBF6028 Series

PART No.	L (uH)	Tolerance	Test Condition	DCR (Ω) Max	IDC (A)
GBF6028NT2R2	2.2	N	100KHZ/0.25V	0.030	1.900
GBF6028NT4R7	4.7	N	100KHZ/0.25V	0.042	1.300
GBF6028NT6R8	6.8	N	100KHZ/0.25V	0.065	1.000
GBF6028MT100	10	M	1KHZ/0.25V	0.094	0.810
GBF6028MT220	22	M	1KHZ/0.25V	0.182	0.550
GBF6028MT330	33	M	1KHZ/0.25V	0.254	0.450
GBF6028MT470	47	M	1KHZ/0.25V	0.338	0.350
GBF6028MT680	68	M	1KHZ/0.25V	0.507	0.315
GBF6028MT101	100	M	1KHZ/0.25V	0.897	0.247
GBF6028MT221	220	M	1KHZ/0.25V	1.560	0.185
GBF6028MT471	470	M	1KHZ/0.25V	3.380	0.125
GBF6028MT102	1000	M	1KHZ/0.25V	7.020	0.082

Electrical characteristics List
GBF7025 Series

PART No.	L(uH)	Tolerance	Test Condition	DCR(Ω)MAX	IDC(A)
GBF7025NT1R5	1.5	N	100KHZ/0.25V	0.022	2.50
GBF7025NT1R8	1.8	N	100KHZ/0.25V	0.026	2.30
GBF7025NT2R5	2.5	N	100KHZ/0.25V	0.030	2.00
GBF7025NT3R3	3.3	N	100KHZ/0.25V	0.035	1.70
GBF7025NT4R7	4.7	N	100KHZ/0.25V	0.046	1.30
GBF7025NT6R8	6.8	N	100KHZ/0.25V	0.060	1.10
GBF7025MT100	10	M	1KHZ/0.25V	0.090	1.05
GBF7025MT120	12	M	1KHZ/0.25V	0.107	0.85
GBF7025MT150	15	M	1KHZ/0.25V	0.146	0.78
GBF7025MT180	18	M	1KHZ/0.25V	0.163	0.68
GBF7025MT220	22	M	1KHZ/0.25V	0.179	0.63
GBF7025MT270	27	M	1KHZ/0.25V	0.231	0.58
GBF7025MT330	33	M	1KHZ/0.25V	0.273	0.52
GBF7025MT390	39	M	1KHZ/0.25V	0.309	0.48
GBF7025MT470	47	M	1KHZ/0.25V	0.364	0.46
GBF7025MT560	56	M	1KHZ/0.25V	0.403	0.38
GBF7025MT680	68	M	1KHZ/0.25V	0.507	0.36
GBF7025MT820	82	M	1KHZ/0.25V	0.611	0.33
GBF7025MT101	100	M	1KHZ/0.25V	0.754	0.31
GBF7025MT121	120	M	1KHZ/0.25V	0.858	0.29
GBF7025MT151	150	M	1KHZ/0.25V	1.12	0.26
GBF7025MT181	180	M	1KHZ/0.25V	1.29	0.23
GBF7025MT221	220	M	1KHZ/0.25V	1.69	0.21
GBF7025MT271	270	M	1KHZ/0.25V	2.25	0.18
GBF7025MT331	330	M	1KHZ/0.25V	2.60	0.17
GBF7025MT391	390	M	1KHZ/0.25V	2.93	0.15
GBF7025MT471	470	M	1KHZ/0.25V	3.77	0.14
GBF7025MT561	560	M	1KHZ/0.25V	4.16	0.13
GBF7025MT681	680	M	1KHZ/0.25V	4.68	0.12
GBF7025MT821	820	M	1KHZ/0.25V	6.24	0.11
GBF7025MT102	1000	M	1KHZ/0.25V	7.41	0.10

Electrical characteristics List

GBF7032 Series

PART No.	L(uH)	Tolerance	Test Condition	DCR(Ω)MAX	IDC(A)
GBF7032NT1R0	1.0	N	100KHZ/0.25V	0.013	3.15
GBF7032NT1R5	1.5	N	100KHZ/0.25V	0.017	2.88
GBF7032NT2R2	2.2	N	100KHZ/0.25V	0.021	2.70
GBF7032NT3R3	3.3	N	100KHZ/0.25V	0.038	2.40
GBF7032NT4R7	4.7	N	100KHZ/0.25V	0.047	2.00
GBF7032NT6R8	6.8	N	100KHZ/0.25V	0.057	1.80
GBF7032MT100	10	M	1KHZ/0.25V	0.069	1.35
GBF7032MT120	12	M	1KHZ/0.25V	0.078	1.25
GBF7032MT150	15	M	1KHZ/0.25V	0.101	1.10
GBF7032MT180	18	M	1KHZ/0.25V	0.135	1.00
GBF7032MT220	22	M	1KHZ/0.25V	0.156	0.90
GBF7032MT270	27	M	1KHZ/0.25V	0.182	0.85
GBF7032MT330	33	M	1KHZ/0.25V	0.208	0.75
GBF7032MT390	39	M	1KHZ/0.25V	0.234	0.68
GBF7032MT470	47	M	1KHZ/0.25V	0.299	0.60
GBF7032MT560	56	M	1KHZ/0.25V	0.332	0.558
GBF7032MT680	68	M	1KHZ/0.25V	0.436	0.50
GBF7032MT820	82	M	1KHZ/0.25V	0.514	0.46
GBF7032MT101	100	M	1KHZ/0.25V	0.592	0.42
GBF7032MT121	120	M	1KHZ/0.25V	0.748	0.40
GBF7032MT151	150	M	1KHZ/0.25V	0.878	0.38
GBF7032MT181	180	M	1KHZ/0.25V	0.982	0.36
GBF7032MT221	220	M	1KHZ/0.25V	1.50	0.32
GBF7032MT271	270	M	1KHZ/0.25V	1.69	0.29
GBF7032MT331	330	M	1KHZ/0.25V	1.95	0.26
GBF7032MT391	390	M	1KHZ/0.25V	2.25	0.24
GBF7032MT471	470	M	1KHZ/0.25V	2.60	0.22
GBF7032MT561	560	M	1KHZ/0.25V	3.62	0.20
GBF7032MT681	680	M	1KHZ/0.25V	4.16	0.18
GBF7032MT821	820	M	1KHZ/0.25V	5.46	0.16
GBF7032MT102	1000	M	1KHZ/0.25V	6.37	0.15

Electrical characteristics List
GBF7045 Series

PART No.	L(uH)	Tolerance	Test Condition	DCR(Ω)MAX	IDC(A)
GBF7045NT1R0	1.0	N	100KHZ/0.25V	0.0150	3.00
GBF7045NT1R8	1.8	N	100KHZ/0.25V	0.0180	2.60
GBF7045NT2R2	2.2	N	100KHZ/0.25V	0.0200	2.40
GBF7045NT3R3	3.3	N	100KHZ/0.25V	0.0325	2.20
GBF7045NT4R7	4.7	N	100KHZ/0.25V	0.0330	2.00
GBF7045MT100	10	M	1KHZ/0.25V	0.0520	1.70
GBF7045MT120	12	M	1KHZ/0.25V	0.0580	1.55
GBF7045MT150	15	M	1KHZ/0.25V	0.0700	1.40
GBF7045MT180	18	M	1KHZ/0.25V	0.0780	1.30
GBF7045MT220	22	M	1KHZ/0.25V	0.0860	1.20
GBF7045MT270	27	M	1KHZ/0.25V	0.1110	1.10
GBF7045MT330	33	M	1KHZ/0.25V	0.1250	1.03
GBF7045MT390	39	M	1KHZ/0.25V	0.1370	0.93
GBF7045MT470	47	M	1KHZ/0.25V	0.1950	0.85
GBF7045MT560	56	M	1KHZ/0.25V	0.2080	0.75
GBF7045MT680	68	M	1KHZ/0.25V	0.2540	0.68
GBF7045MT820	82	M	1KHZ/0.25V	0.2730	0.60
GBF7045MT101	100	M	1KHZ/0.25V	0.3190	0.53
GBF7045MT121	120	M	1KHZ/0.25V	0.4320	0.45
GBF7045MT151	150	M	1KHZ/0.25V	0.5010	0.40
GBF7045MT181	180	M	1KHZ/0.25V	0.7150	0.38
GBF7045MT221	220	M	1KHZ/0.25V	0.8130	0.33
GBF7045MT271	270	M	1KHZ/0.25V	0.9040	0.30
GBF7045MT331	330	M	1KHZ/0.25V	1.01	0.27
GBF7045MT391	390	M	1KHZ/0.25V	1.37	0.26
GBF7045MT471	470	M	1KHZ/0.25V	1.56	0.25
GBF7045MT561	560	M	1KHZ/0.25V	1.76	0.23
GBF7045MT681	680	M	1KHZ/0.25V	2.86	0.21
GBF7045MT821	820	M	1KHZ/0.25V	3.25	0.19
GBF7045MT102	1000	M	1KHZ/0.25V	3.77	0.17

GBF7055 Series

PART No.	L(uH)	Tolerance	Test Condition	DCR(Ω)MAX	IDC(A)
GBF0755NT1R5	1.5	N	100KHZ/0.25V	0.0174	4.0
GBF0755NT2R2	2.2	N	100KHZ/0.25V	0.0217	3.5
GBF0755NT3R3	3.3	N	100KHZ/0.25V	0.0240	3.3
GBF0755NT4R7	4.7	N	100KHZ/0.25V	0.0280	3.1
GBF0755NT6R8	6.8	N	100KHZ/0.25V	0.0340	2.8
GBF0755MT100	10	M	1KHZ/0.25V	0.0391	2.5
GBF0755MT150	15	M	1KHZ/0.25V	0.0508	2.2
GBF0755MT220	22	M	1KHZ/0.25V	0.0643	2.0

Electrical characteristics List

GBF1045 Series

PART No.	L(uH)	Tolerance	Test Condition	DCR(Ω)MAX	IDC(A)
GBF1045MT3R3	3.3	M	100KHZ/0.25V	0.016	3.7
GBF1045MT4R7	4.7	M	100KHZ/0.25V	0.020	3.4
GBF1045MT6R8	6.8	M	100KHZ/0.25V	0.025	2.7
GBF1045MT100	10	M	1KHZ/0.25V	0.036	2.5
GBF1045MT150	15	M	1KHZ/0.25V	0.047	2.2
GBF1045MT220	22	M	1KHZ/0.25V	0.059	1.9
GBF1045MT330	33	M	1KHZ/0.25V	0.082	1.7
GBF1045MT470	47	M	1KHZ/0.25V	0.100	1.5
GBF1045MT560	56	M	1KHZ/0.25V	0.110	1.4
GBF1045MT680	68	M	1KHZ/0.25V	0.140	1.3
GBF1045MT101	100	M	1KHZ/0.25V	0.200	1.1
GBF1045MT151	150	M	1KHZ/0.25V	0.350	0.81
GBF1045MT221	220	M	1KHZ/0.25V	0.470	0.7
GBF1045MT331	330	M	1KHZ/0.25V	0.680	0.58
GBF1045MT471	470	M	1KHZ/0.25V	1.030	0.47
GBF1045MT681	680	M	1KHZ/0.25V	1.600	0.38
GBF1045MT102	1000	M	1KHZ/0.25V	2.800	0.29
GBF1045MT152	1500	M	1KHZ/0.25V	3.400	0.26

GBF1065 Series

PART No.	L(uH)	Tolerance	Test Condition	DCR(Ω)MAX	IDC(A)
GBF1065NT1R5	1.5	N	100KHZ/0.25V	0.0067	6.8
GBF1065NT2R2	2.2	N	100KHZ/0.25V	0.0084	6.3
GBF1065NT3R3	3.3	N	100KHZ/0.25V	0.0096	5.8
GBF1065NT4R7	4.7	N	100KHZ/0.25V	0.0117	4.7
GBF1065NT6R8	6.8	N	100KHZ/0.25V	0.0140	4.3
GBF1065MT100	10	M	1KHZ/0.25V	0.0185	3.8
GBF1065MT150	15	M	1KHZ/0.25V	0.0270	3.1
GBF1065MT220	22	M	1KHZ/0.25V	0.0448	2.4

Electrical characteristics List
GBF1255 Series

PART No.	L(uH)	Tolerance	Test Condition	DCR(Ω)MAX	IDC(A)
GBF1255NT6R0	6.0	N	100KHZ/0.25V	0.0164	4.90
GBF1255MT100	10	M	1KHZ/0.25V	0.0215	4.30
GBF1255MT150	15	M	1KHZ/0.25V	0.0259	3.90
GBF1255MT220	22	M	1KHZ/0.25V	0.0338	3.40
GBF1255MT330	33	M	1KHZ/0.25V	0.0415	3.10
GBF1255MT470	47	M	1KHZ/0.25V	0.0618	2.50
GBF1255MT560	56	M	1KHZ/0.25V	0.0750	2.30
GBF1255MT680	68	M	1KHZ/0.25V	0.0832	2.20
GBF1255MT101	100	M	1KHZ/0.25V	0.1170	1.80
GBF1255MT151	150	M	1KHZ/0.25V	0.1900	1.40
GBF1255MT221	220	M	1KHZ/0.25V	0.2700	1.20
GBF1255MT331	330	M	1KHZ/0.25V	0.4100	1.00
GBF1255MT471	470	M	1KHZ/0.25V	0.5200	0.88
GBF1255MT681	680	M	1KHZ/0.25V	0.7600	0.73
GBF1255MT102	1000	M	1KHZ/0.25V	1.1200	0.60
GBF1255MT152	1500	M	1KHZ/0.25V	1.7300	0.48

GBF1265 Series

PART No.	L(uH)	Tolerance	Test Condition	DCR (Ω)MAX	IDC(A)
GBF1265NT2R0	2.0	N	100KHZ/0.25V	0.0117	6.2
GBF1265NT4R2	4.2	N	100KHZ/0.25V	0.0150	5.5
GBF1265MT7R0	7.0	M	100KHZ/0.25V	0.0177	5.0
GBF1265MT100	10	M	1KHZ/0.25V	0.0202	4.8
GBF1265MT150	15	M	1KHZ/0.25V	0.0237	4.4
GBF1265MT220	22	M	1KHZ/0.25V	0.0316	3.8
GBF1265MT330	33	M	1KHZ/0.25V	0.0406	3.4
GBF1265MT470	47	M	1KHZ/0.25V	0.0578	2.8
GBF1265MT560	56	M	1KHZ/0.25V	0.0750	2.5
GBF1265MT680	68	M	1KHZ/0.25V	0.0787	2.4
GBF1265MT101	100	M	1KHZ/0.25V	0.1230	1.9
GBF1265MT121	120	M	1KHZ/0.25V	0.1850	1.5
GBF1265MT151	150	M	1KHZ/0.25V	0.2730	1.2

Electrical characteristics List

GBF1275 Series

PART No.	L(uH)	Tolerance	Test Condition	DCR(Ω)MAX	IDC(A)
GBF1275NT1R2	1.2	N	100KHZ/0.25V	0.0069	8.2
GBF1275NT2R7	2.7	N	100KHZ/0.25V	0.0094	7.0
GBF1275NT3R9	3.9	N	100KHZ/0.25V	0.0104	6.7
GBF1275NT5R6	5.6	N	100KHZ/0.25V	0.0116	6.3
GBF1275NT6R8	6.8	N	100KHZ/0.25V	0.0131	5.9
GBF1275MT100	10	M	1KHZ/0.25V	0.0156	5.4
GBF1275MT150	15	M	1KHZ/0.25V	0.0184	5.0
GBF1275MT220	22	M	1KHZ/0.25V	0.0263	4.0
GBF1275MT330	33	M	1KHZ/0.25V	0.0395	3.4
GBF1275MT470	47	M	1KHZ/0.25V	0.0528	3.0
GBF1275MT560	56	M	1KHZ/0.25V	0.0670	2.6
GBF1275MT680	68	M	1KHZ/0.25V	0.0778	2.4
GBF1275MT101	100	M	1KHZ/0.25V	0.1250	1.9
GBF1275MT151	150	M	1KHZ/0.25V	0.1750	1.6
GBF1275MT221	220	M	1KHZ/0.25V	0.2580	1.3